



**GE Healthcare  
Project Management**

GE Healthcare has made reasonable efforts to ensure this BIM file conforms to requirements of the applicable pre-installation manual. This BIM file was produced to assist with site planning and is not intended for construction or final building modeling. GE Healthcare is not responsible for any damages resulting from use of such file for construction or final building modeling purposes. Compliance with all applicable local, state, and federal laws and regulations is the responsibility of the customer or its designated architects and engineers. Please keep in mind the information in this BIM file is dynamic and is subject to change without notice. It is the responsibility of the customer or its designated architect(s) and engineer(s) to ensure they have the latest equipment or product information.

**INNOVA PLUS - RENDERING**

<b>Project number</b>	<b>5-90</b>
<b>Date</b>	<b>10.FEB.17</b>
<b>Drawn by</b>	<b>GENPACT</b>
<b>Checked by</b>	

**A-1**

**Scale 12" = 1'-0"**

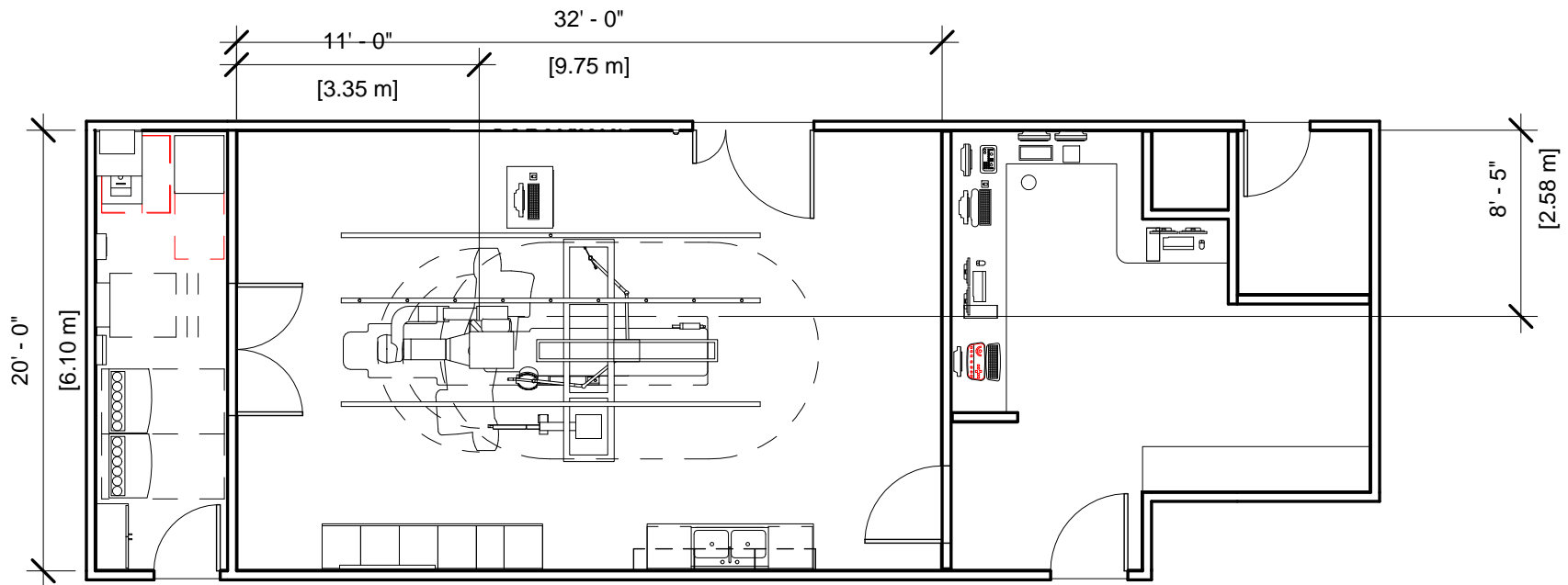

**GE Healthcare  
Project Management**

GE Healthcare has made reasonable efforts to ensure this BIM file conforms to requirements of the applicable pre-installation manual. This BIM file was produced to assist with site planning and is not intended for construction or final building modeling. GE Healthcare is not responsible for any damages resulting from use of such file for construction or final building modeling purposes. Compliance with all applicable local, state, and federal laws and regulations is the responsibility of the customer or its designated architects and engineers. Please keep in mind the information in this BIM file is dynamic and is subject to change without notice. It is the responsibility of the customer or its designated architect(s) and engineer(s) to ensure they have the latest equipment or product information.

**INNOVA PLUS FLOOR PLAN**

<b>Project number</b>	<b>5-90</b>
<b>Date</b>	<b>10.FEB.17</b>
<b>Drawn by</b>	<b>GENPACT</b>
<b>Checked by</b>	

**A-2**

**Scale 1/8" = 1'-0"**

### Specialty Equipment Schedule

Description	Weight (lbs)	BTU
<b>CONTROL ROOM</b>		
VATALINQ SPEAKER	0	0
VATALINQ CONSOLE	0	0
REMOTE CONTROL FOR INJECTOR	4	0
MAC LAB	566	2935
CONTROL ROOM MONITOR WITH DL KEYPAD	22	204
TWO STACKED 18" MONITORS ON WALL SUPPORT	26	204
Advantage Workstation	81 lbs	1201
TWO STACKED 18" MONITORS ON WALL SUPPORT	26	204
IVUS VOLCANO S5i CONSOLE	68	1631
OPERATORS CONSOLE	22	546

### EQUIPMENT ROOM

UPS INTERFACE BOX	0	0
WATER CHILLER	449	18716
INJECTOR ELECTRONICS	37	320
MAIN DISCONNECT	326	1532
DETECTOR CHILLER	33	706
Atlas Cabinet	659	1825
Atlas Cabinet-C1	1115	3389
UPS CABINET	1170	4061
LOTO Disconnect	0	0
STORAGE CABINET	0	0

### Specialty Equipment Schedule

Description	Weight (lbs)	BTU
<b>EXAM ROOM</b>		
FOUR LCD MONITOR SUSPENSION	485	1157
VATALINQ MICROPHONE	0	0
OMEGA IV/V TABLE WITH ROTATING TOP	1750	614
INJECTOR HEAD ON TABLE	15	0
COUNTERBALANCED EYE AND THYROID SHIELD	143	0
INNOVA POSITIONER	1653	2416
NURSE WORSTATION	46	692



**GE Healthcare  
Project Management**

GE Healthcare has made reasonable efforts to ensure this BIM file conforms to requirements of the applicable pre-installation manual. This BIM file was produced to assist with site planning and is not intended for construction or final building modeling. GE Healthcare is not responsible for any damages resulting from use of such file for construction or final building modeling purposes. Compliance with all applicable local, state, and federal laws and regulations is the responsibility of the customer or its designated architects and engineers. Please keep in mind the information in this BIM file is dynamic and is subject to change without notice. It is the responsibility of the customer or its designated architect(s) and engineer(s) to ensure they have the latest equipment or product information.

### INNOVA PLUS SCHEDULE

Project number	5-90
Date	10.FEB.17
Drawn by	GENPACT
Checked by	

**A-3**

Scale

Hold the Left Click for Rotating around  
Use the Scroll for Zooming in and out



5-90 - Single-Plane Innova 2100-3100-4100 Plus



[Click for Site Planning Support](#)