

DIAMOND MAMMOGRAPHY SYSTEM

RECOMMENDED CEILING HEIGHT
8'-0" [2438mm]

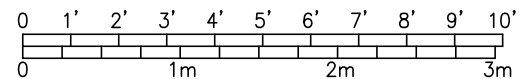

MINIMUM: 8'-0" x 8'-0" [2.44m x 2.44m] 7'-6" [2.29m]

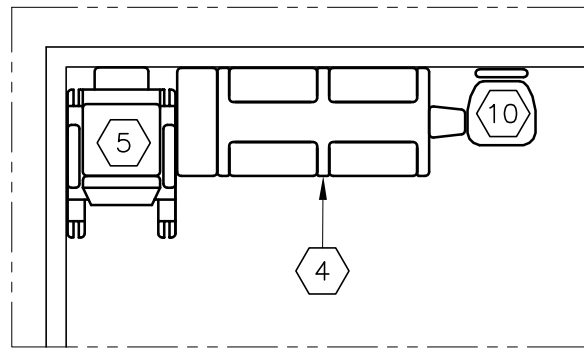
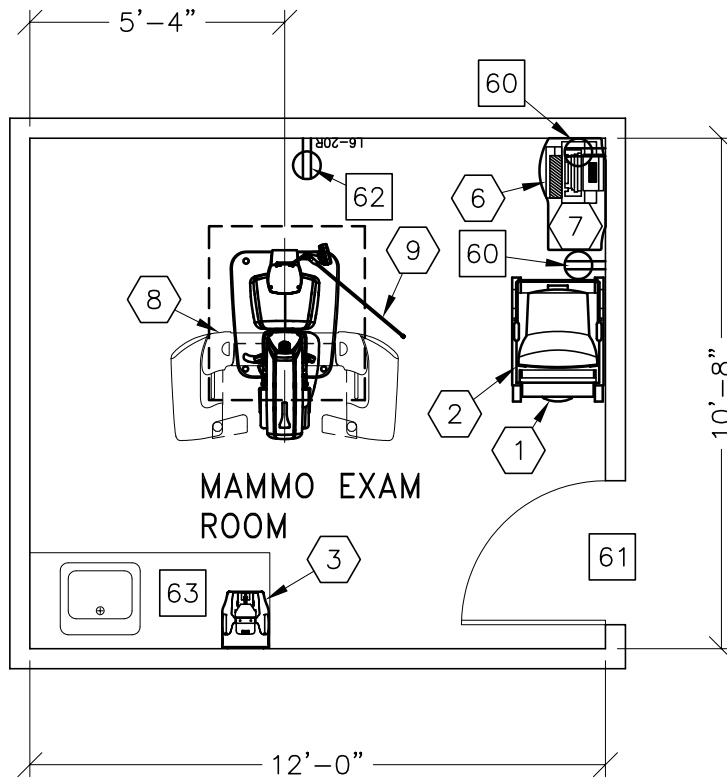

9-30

①	1 DELTA 32 MONITOR	77 lbs	
②	1 DELTA 32 WORKSTATION ON CART	66 lbs	
③	1 DELTA 32 STEREOTACTIC CAMERA	17 lbs	
④	1 DBI IMAGING TABLE	315 lbs	
⑤	1 MAMMOGRAPHY AND BIOPSY CHAIR	160 lbs	
⑥	1 ALPHA ID FILM MARKING SYSTEM	24 lbs	170 btu
⑦	1 ALPHA STORE	160 lbs	
⑧	1 DIAMOND MAMMOGRAPHY SYSTEM	771 lbs	546 btu
⑨	1 MOUNTED RADIATION SHIELD	143 lbs	
⑩	1 HYDRAULIC		

CUSTOMER/CONTRACTOR SUPPLIED AND INSTALLED ITEMS

- ⑥0 DUPLEX HOSPITAL GRADE RECEPTACLE AND COVERPLATE
- ⑥1 MINIMUM DOOR OPENING FOR EQUIPMENT DELIVERY IS
 36 IN. W x 82 IN. H [914mm x 2083mm], CONTINGENT ON
 A 96 IN. [2438mm] CORRIDOR WIDTH
- ⑥2 DEDICATED 220-240V, 20A, NEMA L6-20R RECEPTACLE AND
 PLUG
- ⑥3 COUNTER TOP WITH SINK AND BASE CABINETS

60-75° F [10-24° C]
 5° F [3° C] per hour
 15-85 percent non condensing
 5 percent per hour
 N/A