



**GE Healthcare
Project Management**

GE Healthcare has made reasonable efforts to ensure this BIM file conforms to requirements of the applicable pre-installation manual. This BIM file was produced to assist with site planning and is not intended for construction or final building modeling. GE Healthcare is not responsible for any damages resulting from use of such file for construction or final building modeling purposes. Compliance with all applicable local, state, and federal laws and regulations is the responsibility of the customer or its designated architects and engineers. Please keep in mind the information in this BIM file is dynamic and is subject to change without notice. It is the responsibility of the customer or its designated architect(s) and engineer(s) to ensure they have the latest equipment or product information.

INNOVA 3100/ 4100 - RENDERING

Project number	4-58
Date	13.FEB.17
Drawn by	GENPACT
Checked by	

A-1

Scale 12" = 1'-0"

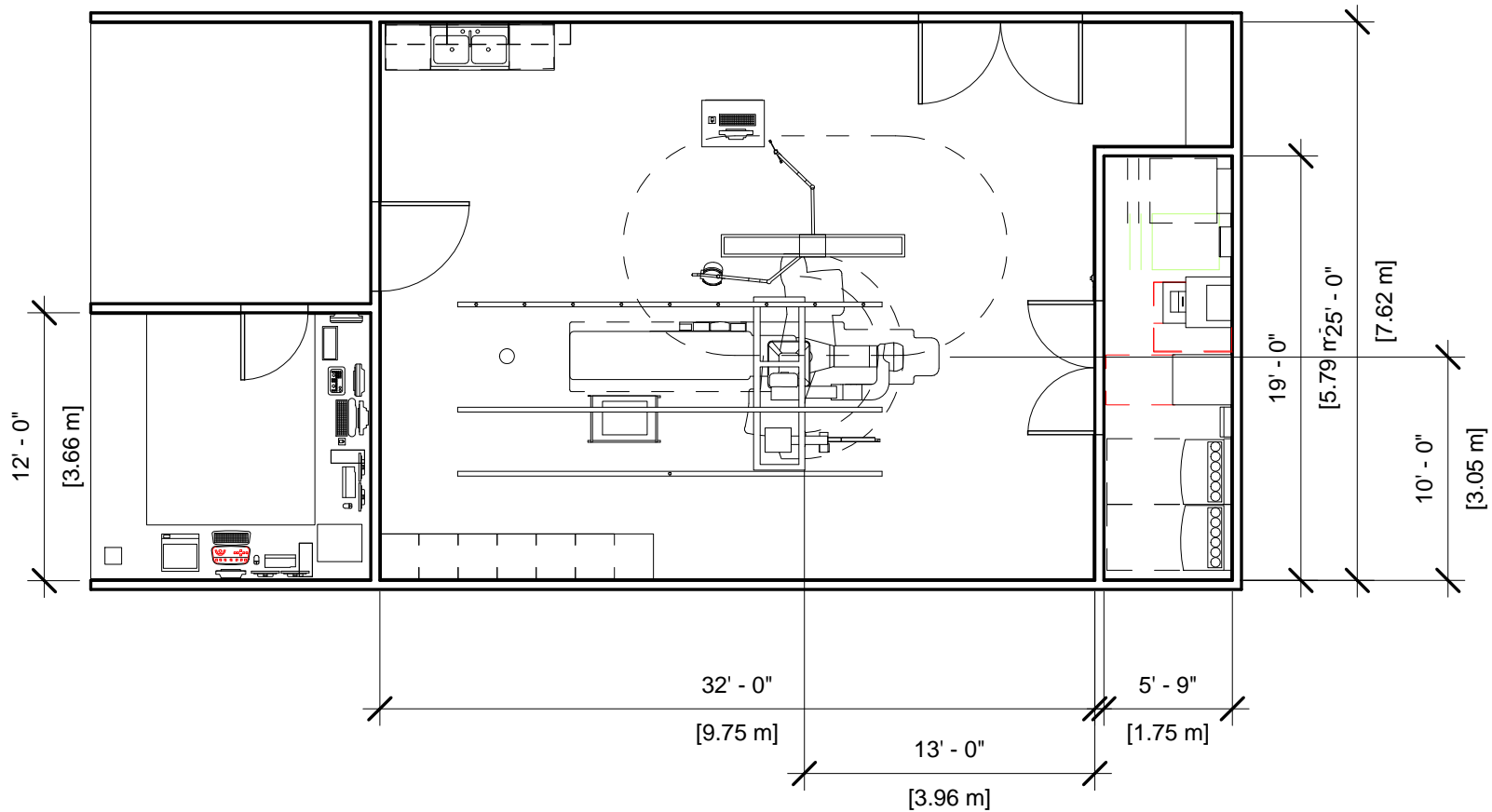

GE Healthcare
Project Management

GE Healthcare has made reasonable efforts to ensure this BIM file conforms to requirements of the applicable pre-installation manual. This BIM file was produced to assist with site planning and is not intended for construction or final building modeling. GE Healthcare is not responsible for any damages resulting from use of such file for construction or final building modeling purposes. Compliance with all applicable local, state, and federal laws and regulations is the responsibility of the customer or its designated architects and engineers. Please keep in mind the information in this BIM file is dynamic and is subject to change without notice. It is the responsibility of the customer or its designated architect(s) and engineer(s) to ensure they have the latest equipment or product information.

INNOVA 3100/ 4100 FLOOR PLAN

Project number	4-58
Date	13.FEB.17
Drawn by	GENPACT
Checked by	

A-2

Scale 1/8" = 1'-0"

Specialty Equipment Schedule

Description	Weight (lbs)	BTU
CONTROL ROOM		
INJECTOR ELECTRONICS	37	320
ATLAS CABINET C2	568	1825
UPS INTERFACE BOX	0	0
UPS CABINET	1170	4050
DETECTOR CHILLER	33	706
WATER CHILLER	449	18716
ATLAS CABINET C1	998	3389
FILTER ENCLOSURE	90	0
MAIN DISCONNECT	275	1532
EQUIPMENT ROOM		
IVUS VOLCANO S5i CONSOLE	68	1631
CARDIO LAB CONSOLE	181	2935
COLOR PRINTER	0	1054
TWO STACKED 18" MONITORS ON WALL SUPPORT	26	204
REMOTE CONTROL FOR INJECTOR	4	0
CONTROL ROOM MONITOR WITH DL KEYPAD	19	204
OPERATORS CONSOLE	22	546
AW WORKSTATION	81	1201
VATALINQ CONSOLE	0	0
VATALINQ MICROPHONE	0	0
EXAM ROOM		
NURSE WORKSTATION	46	682
OMEGA IV/V TABLE WITH ROTATING TOP	1750	600
COUNTERBALANCED SHIELD AND THYROID SHIELD WITH LAMP	143	0
INNOVA POSITIONER	1653	2416
LOGIQ ULTRASOUND UNIT	0	0
VATALINQ SPEAKER	0	0
SIX LCD MONITOR SUSPENSION	557	1228



**GE Healthcare
Project Management**

GE Healthcare has made reasonable efforts to ensure this BIM file conforms to requirements of the applicable pre-installation manual. This BIM file was produced to assist with site planning and is not intended for construction or final building modeling. GE Healthcare is not responsible for any damages resulting from use of such file for construction or final building modeling purposes. Compliance with all applicable local, state, and federal laws and regulations is the responsibility of the customer or its designated architects and engineers. Please keep in mind the information in this BIM file is dynamic and is subject to change without notice. It is the responsibility of the customer or its designated architect(s) and engineer(s) to ensure they have the latest equipment or product information.

INNOVA 3100/ 4100-SCHEDULE

Project number	4-58
Date	13.FEB.17
Drawn by	GENPACT
Checked by	

A-3

Scale

Hold the Left Click for Rotating around
Use the Scroll for Zooming in and out



4-58 - Single-Plane - Innova 2100-3100-4100 Unity



GE Healthcare

[Click for Site Planning Support](#)