



**GE Healthcare
Project Management**

GE Healthcare has made reasonable efforts to ensure this BIM file conforms to requirements of the applicable pre-installation manual. This BIM file was produced to assist with site planning and is not intended for construction or final building modeling. GE Healthcare is not responsible for any damages resulting from use of such file for construction or final building modeling purposes. Compliance with all applicable local, state, and federal laws and regulations is the responsibility of the customer or its designated architects and engineers. Please keep in mind the information in this BIM file is dynamic and is subject to change without notice. It is the responsibility of the customer or its designated architect(s) and engineer(s) to ensure they have the latest equipment or product information.

Signa PET/MR - RENDERING

Project number	8-262
Date	08.NOV.16
Drawn by	Genpact
Checked by	-

A-1

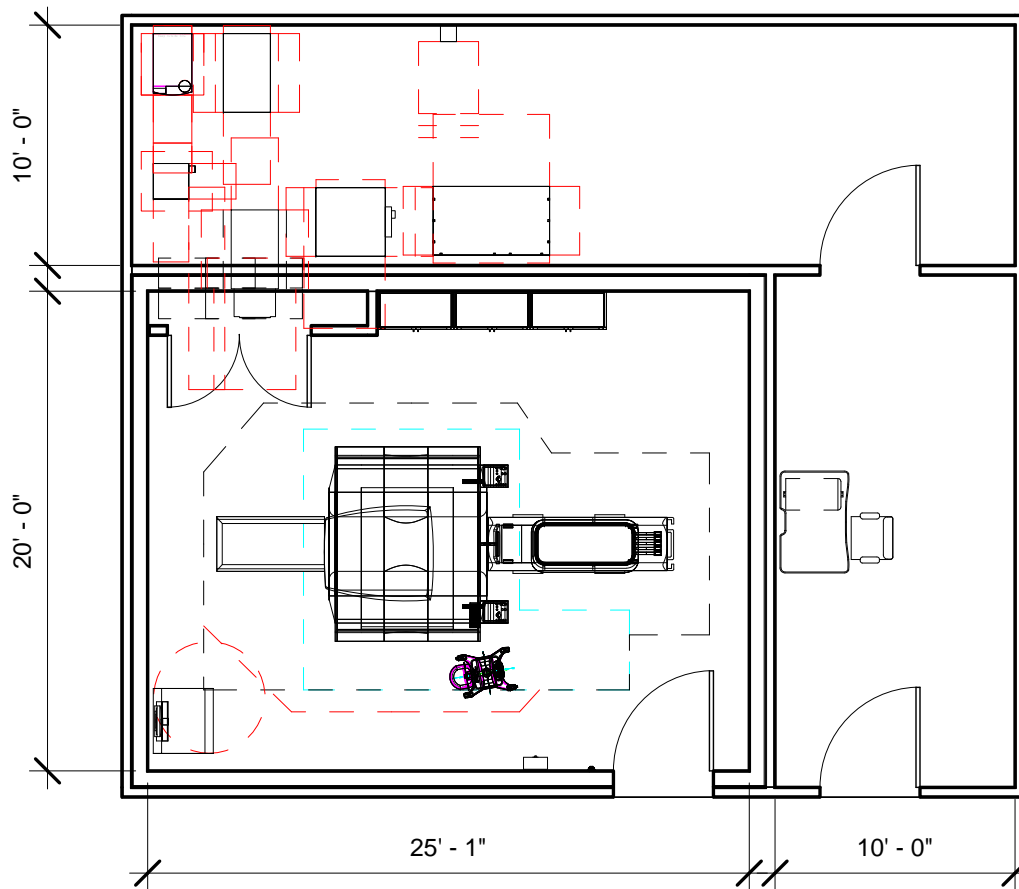

**GE Healthcare
Project Management**

GE Healthcare has made reasonable efforts to ensure this BIM file conforms to requirements of the applicable pre-installation manual. This BIM file was produced to assist with site planning and is not intended for construction or final building modeling. GE Healthcare is not responsible for any damages resulting from use of such file for construction or final building modeling purposes. Compliance with all applicable local, state, and federal laws and regulations is the responsibility of the customer or its designated architects and engineers. Please keep in mind the information in this BIM file is dynamic and is subject to change without notice. It is the responsibility of the customer or its designated architect(s) and engineer(s) to ensure they have the latest equipment or product information.

Signa PET/MR - PLAN

Project number	8-262
Date	08.NOV.16
Drawn by	Genpact
Checked by	-

A-2

Scale 1/8" = 1'-0"

Specialty Equipment Schedule

Description	Weight lbs	BTU
3.0 TESLA ACTIVE SHIELD MAGNET	17460	11911
BLOWER BOX	0	1535
DC LIGHTING CONTROL PANEL	155	1024
DC LIGHTING TRANSFORMER	60	171
HEAT EXCHANGER CABINET	1349	3412
MAGNET MONITOR	11	819
MAGNET RUNDOWN UNIT	8	0
MAIN DISCONNECT CONTROL	130	901
MANUAL CRYOGEN COMPRESSOR WATER BYPASS PANEL	0	0
OPERATOR WORKSPACE CABINET	141	0
OPERATOR WORKSPACE WITH LCD MONITOR	26	4948
PATIENT ALERT CONTROL BOX	0	0
PATIENT TRANSPORT TABLE	418	0
PEN PANEL CABINET	639	11722
PET CHILLER	304	23890
PET ELECTRONICS CABINET	813	13037
PIPING FOR COOLING SYSTEM	0	0
POWER, GRADIENT, RF CABINET	3143	20945
REAR PEDESTAL	213	0
RF FILTERS	0	0
RF PENETRATION PANEL	92	0
ROOM SUPPLY CABINET	0	0
SHIELD COOLER CABINET	264	1706
SPT PHANTOM CABINET	350	0
WATER FILTER	0	0
WORKSTATION TABLE	0	0



**GE Healthcare
Project Management**

GE Healthcare has made reasonable efforts to ensure this BIM file conforms to requirements of the applicable pre-installation manual. This BIM file was produced to assist with site planning and is not intended for construction or final building modeling. GE Healthcare is not responsible for any damages resulting from use of such file for construction or final building modeling purposes. Compliance with all applicable local, state, and federal laws and regulations is the responsibility of the customer or its designated architects and engineers. Please keep in mind the information in this BIM file is dynamic and is subject to change without notice. It is the responsibility of the customer or its designated architect(s) and engineer(s) to ensure they have the latest equipment or product information.

Signa PET/MR - SCHEDULE

Project number	8-262
Date	08.NOV.16
Drawn by	Author
Checked by	Checker

A-3

Scale

Hold the Left Click for Rotating around
Use the Scroll for Zooming in and out



SIGNA PET/MR



GE Healthcare

[Click for Site Planning Support](#)