

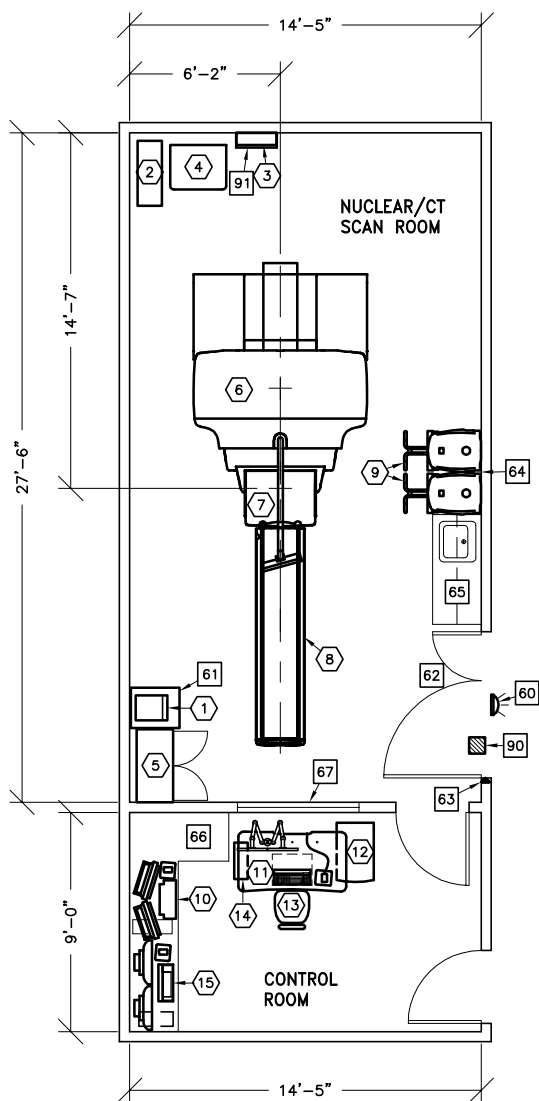

DISCOVERY NM/CT 670DR

NOTE: THIS IS A SUGGESTED LAYOUT BASED OFF OF GE HEALTHCARE PRE-INSTALL MANUAL. PLEASE CONTACT LOCAL PROJECT MANAGER OF INSTALLATION IF YOUR ROOM LAYOUT OR DIMENSIONS ARE DIFFERENT THAN THE LAYOUT SHOWN.



DRAWING SCALED
2:1 DIMENSIONS
EDITED

| ROOM DIMENSIONS | LENGTH & WIDTH | CEILING HEIGHT |
|-----------------|----------------------------------|----------------|
| MINIMUM: | Refer to Pre-Installation Manual | |

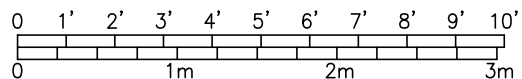

ROOM PLAN LOCATED ON PAGE 7-92

| ITEM | QUANTITY | ITEM DESCRIPTION | WEIGHT | HEAT OUTPUT |
|------|----------|---|----------|-------------|
| ① | 1 | R-WAVE TRIGGER UNIT | 19 lbs | 170 btu |
| ② | 1 | UPS SYSTEM | 350 lbs | 5003 btu |
| ③ | 1 | POWER INPUT DISTRIBUTION BOX | 154 lbs | |
| ④ | 1 | POWER DISTRIBUTION UNIT | 771 lbs | 5119 btu |
| ⑤ | 1 | STORAGE CABINET <EMPTY CABINET WEIGHT> | 99 lbs | |
| ⑥ | 1 | DISCOVERY NM/CT 670 GANTRY <CT> | 3899 lbs | 18771 btu |
| ⑦ | 1 | DISCOVERY NM/CT 670 GANTRY <NUCLEAR> | 4629 lbs | 4498 btu |
| ⑧ | 1 | DISCOVERY NM/CT 670 TABLE | 1521 lbs | 682 btu |
| ⑨ | 2 | DISCOVERY NM/CT 670 COLLIMATOR CART | 551 lbs | |
| ⑩ | 1 | XELERIS WORKSTATION | 55 lbs | 255 btu |
| ⑪ | 1 | FREEDOM WORKSPACE-LARGE TABLE | 147 lbs | 8191 btu |
| ⑫ | 1 | T. I. O. CABINET | 194 lbs | 255 btu |
| ⑬ | 1 | OPERATOR'S CHAIR | | |
| ⑭ | 1 | NUCLEAR AQUISITION COMPUTER | 33 lbs | 255 btu |
| ⑮ | 1 | ADVANTAGE WORKSTATION WITH TWO LCD MONITORS | 81 lbs | 1109 btu |

ENVIRONMENT

Ambient Operation Temperature: 64-79° F [18-26° C]
 Allowable Temperature Change: 5° F [3° C] per hour
 Humidity: 30-60 percent non condensing
 Allowable Humidity Change: 5 percent per hour
 Max - Altitude: 7875 FT. [2400 M]

ROOM PLAN LOCATED ON PAGE

| ITEM | QUANTITY | ITEM DESCRIPTION | WEIGHT | HEAT OUTPUT |
|------|----------|---|--------|-------------|
| | | <p>***** CUSTOMER/CONTRACTOR SUPPLIED AND INSTALLED ITEMS *****</p> | | |
| 60 | | X-RAY ON WARNING LIGHT - AVAILABLE FROM GE SUPPLY CALL: 800-200-9760, GE CAT. NO. WXIABWW-OF-XIU | | |
| 61 | | CART | | |
| 62 | | MINIMUM DOOR OPENING FOR EQUIPMENT DELIVERY IS 44 IN. W x 83 IN. H [1118mm x 2108mm], CONTINGENT ON A 96 IN. [2438mm] CORRIDOR WIDTH | | |
| 63 | | DOOR LIMIT SWITCH <REQUIRED IN , SOUTH CAROLINA OTHERWISE NEEDED ONLY IF REQUIRED BY STATE/LOCAL CODES> | | |
| 64 | | OPTIONAL WALL PROTECTION FROM COLLIMATOR CART. ALSO, FINISHED FLOORING COULD BE SUBJECT TO DAMAGE DURING MOVEMENT AND BEING PARKED FOR A LONG PERIOD. SUFFICIENT FLOORING MUST BE USED TO PREVENT DAMAGE. | | |
| 65 | | COUNTER TOP WITH SINK, BASE AND WALL CABINETS | | |
| 66 | | COUNTER TOP FOR EQUIPMENT-PROVIDE GROMMETED OPENINGS AS REQUIRED TO ROUTE INTERCONNECT CABLES TO RACEWAY BELOW COUNTERTOP | | |
| 67 | | CONTROL WALL TO CEILING WITH LEAD GLASS WINDOW | | |
| 90 | | X-RAY ROOM WARNING LIGHT CONTROL PANEL, REFERENCE JUNCTION POINT 'WLC' ON SHEET 'E1' FOR DETAILED DESCRIPTION-E4502RL FOR WARNING LIGHT CONTROL ONLY | | |
| 91 | | MAIN DISCONNECT CONTROL, GEMS CAT. NO. E4502AE, 125 lbs. , SEE DETAIL E4502AE. | | |