

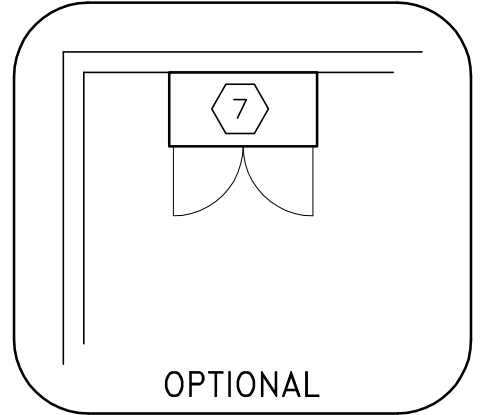

CARDIOGRAPHE CT

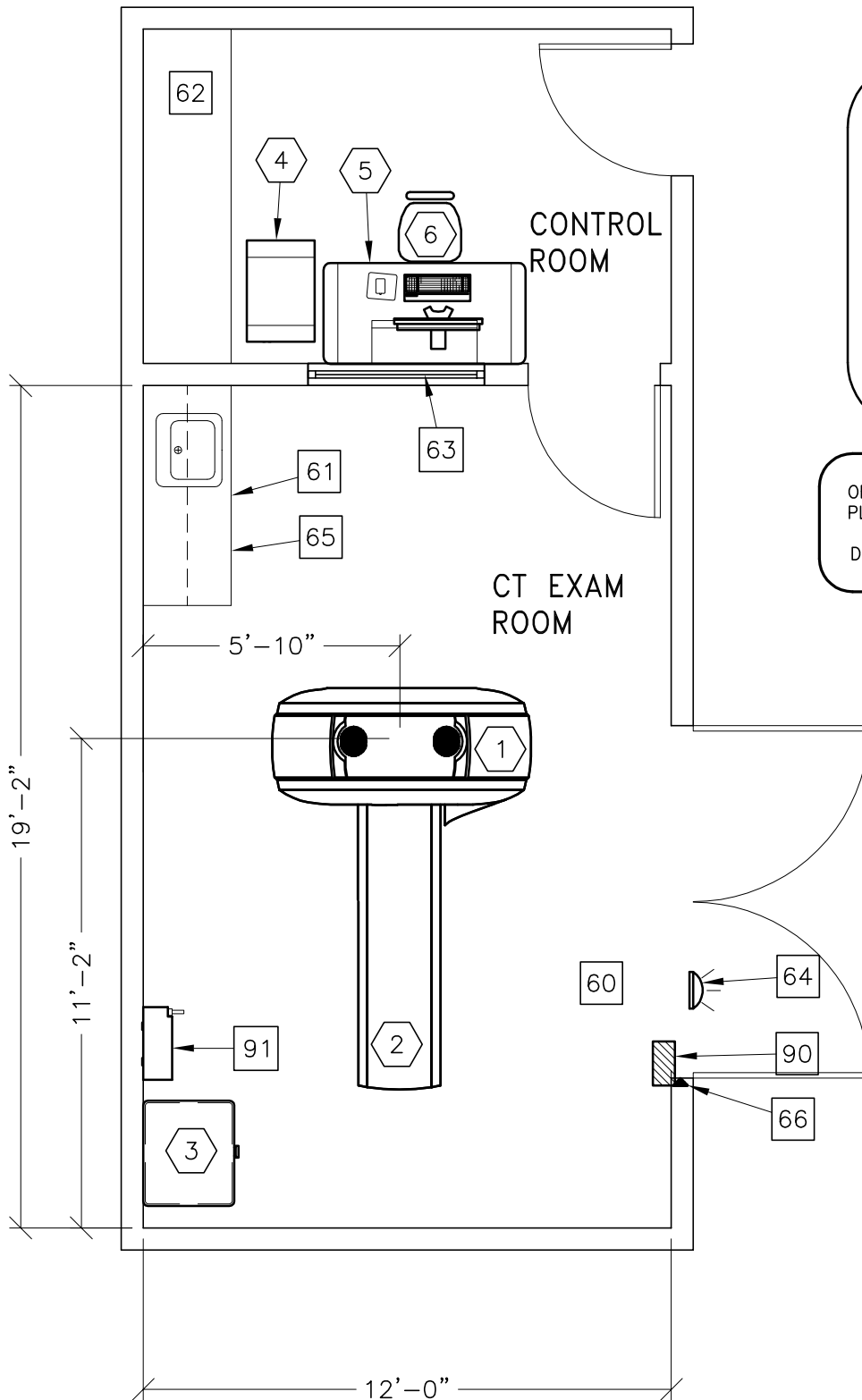

NOTE: THIS IS A SUGGESTED LAYOUT BASED OFF OF GE HEALTHCARE PRE-INSTALL MANUAL. PLEASE CONTACT LOCAL PROJECT MANAGER OF INSTALLATION IF YOUR ROOM LAYOUT OR DIMENSIONS ARE DIFFERENT THAN THE LAYOUT SHOWN.

ROOM DIMENSIONS	LENGTH & WIDTH	CEILING HEIGHT
TYPICAL:	20'-8" x 13'-2" [6.30M x 4.00M]	9'-0" [2.74M]

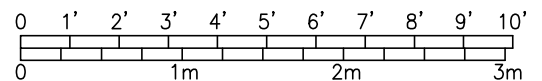

ROOM PLAN LOCATED ON PAGE 6-114

ITEM	QUANTITY	ITEM DESCRIPTION	WEIGHT	HEAT OUTPUT
①	1	CARDIOGRAPHE CT GANTRY <INCLUDES TABLE BTU'S>	3626 lbs	20500 btu
②	1	PATIENT TABLE	1025 lbs	
③	1	POWER DISTRIBUTION UNIT	795 lbs	1201 btu
④	1	OPERATORS CONSOLE	119 lbs	5800 btu
⑤	1	WORKSTATION DESK		
⑥	1	OPERATOR'S CHAIR		
⑦	1	STORAGE CABINET <EMPTY CABINET WEIGHT>	99 lbs	
***** CUSTOMER/CONTRACTOR SUPPLIED AND INSTALLED ITEMS *****				
60		MINIMUM DOOR OPENING FOR EQUIPMENT DELIVERY IS 46 IN. W x 78 IN. H [1168.4mm x 1980mm], CONTINGENT ON A 96 IN. [2438.4mm] CORRIDOR WIDTH		
61		COUNTER TOP WITH SINK, BASE AND WALL CABINETS		
62		COUNTER TOP FOR EQUIPMENT-MINIMUM DEPTH 30 in. OR ADDITIONAL SHELVING MAY BE REQUIRED PROVIDE GROMMETED OPENINGS AS REQUIRED TO ROUTE INTERCONNECT CABLES TO RACEWAY BELOW COUNTERTOP.		
63		LEAD GLASS WINDOW		
64		X-RAY ON WARNING LIGHT - AVAILABLE FROM GE SUPPLY CALL: 800-200-9760 GE CAT. NO. WXIABWW-OF-XIU		
65		CASEWORK REQUIRED WITH A MINIMUM OF 16 CUBIC FEET TO STORE ALL SERVICE MATERIALS		
66		DOOR LIMIT SWITCH <REQUIRED IN SOUTH CAROLINA, OTHERWISE NEEDED ONLY IF REQUIRED BY STATE/LOCAL CODES>		
90		X-RAY ROOM WARNING LIGHT CONTROL PANEL REFERENCE JUNCTION POINT 'WLC' ON SHEET 'E1' FOR DETAILED DESCRIPTION -E4502RL FOR WARNING LIGHT CONTROL ONLY		
91		MAIN DISCONNECT CONTROL		

ENVIRONMENT

Ambient Operation Temperature: 68-79° (F) 20-26° C
 Allowable Temperature Change: 5° F [3° C] per hour
 Humidity: 30-60 percent non condensing
 Allowable Humidity Change: 5 percent per hour
 Max - Altitude: 9843 [3000M] ft. above sea level